



REFRIGERATION

SERVING THE FOOD INDUSTRY SINCE 1951

71-INCH CURVED GLASS FLOOR REFRIGERATED DISPLAY CASE

Item: 44253 Model: RS-CN-0650

ATTRACTIVELY DISPLAY FOOD MERCHANDISE AND INCREASE IMPULSE SALE

Omcans Curved Glass Floor Refrigerated Display Case provides an economical solution for displaying your products. Features an exterior tempered glass finish and interior LED lighting, this refrigerated showcase also has an automatic defrost system and fan cooling system. Easy to use and clean. Ideal for deli shops, cafes, and sandwich shops.



WARRANTY
PARTS AND LABOR

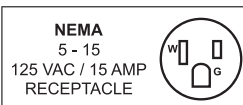

Authorized Dealer

REFRIGERATION

650 L / 22.95 CU. FT CURVED GLASS DISPLAY CASE



TECHNICAL SPECIFICATIONS

ITEM NUMBER	44253
MODEL	RS-CN-0650
CAPACITY	650 L / 22.95 cu. ft
TEMPERATURE	2°C - 8°C / 36°F - 46°F
COMPRESSOR	1/2 HP
AMPS	12A
REFRIGERANT	R134A
NO. OF SHELVES	3
CORD LENGTH	4 ft.
ELECTRICAL	115V / 60Hz / 1Ph
DIMENSIONS (WDH)	70.8" x 29.3" x 53.1" 1798 x 744 x 1350 mm
WEIGHT	860 lbs. / 390 kg.
PACKAGING DIMENSIONS	75.2" x 33" x 59.4" 1910 x 838 x 1509 mm
PACKAGING WEIGHT	903 lbs./ 409.6 kgs.

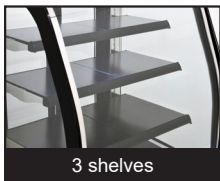

TECHNICAL DRAWINGS AND DIMENSIONS

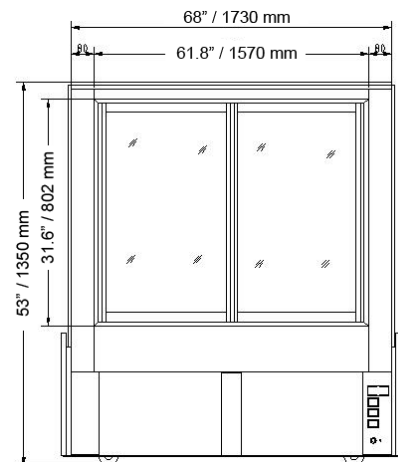
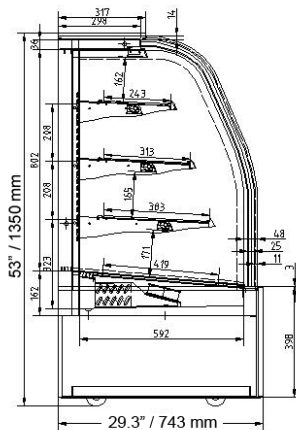
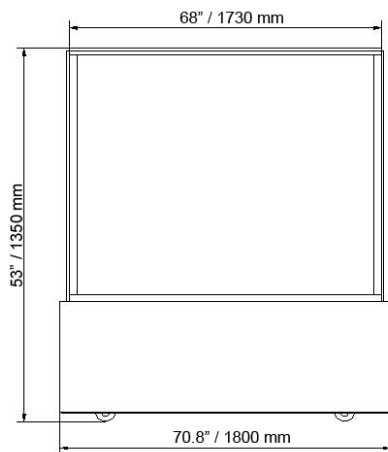

OMCAN INC.

Telephone: 1-800-465-0234
 Fax: (905) 607-0234
 Email: sales@omcan.com
 Website: www.omcan.com



Follow us to keep up to date with the latest news and offers

